

1. fit U bolt (3) through guard (1), fit guard (1) to tyne making sure the lower edge is correctly located in the lugs of holder. Fit lug (2) over U bolt (3) and secure with nuts (4) - DO NOT OVER TIGHTEN.

RETENSION ALL BOLTS AFTER 8 hrs WORKING

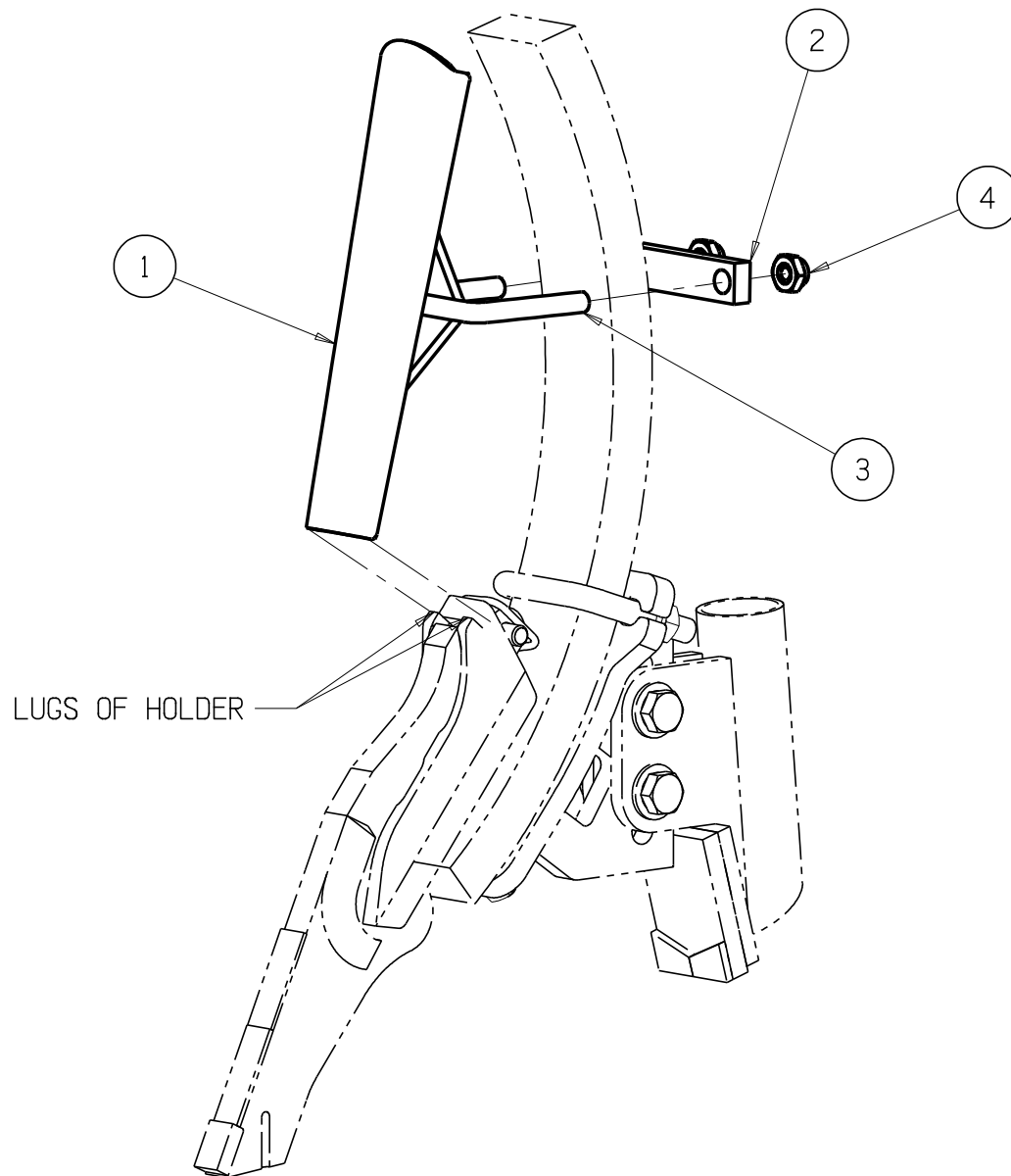

4	2	NU10MNY		NYLOC NUT M10
3	1	UB1003		U BOLT FOR 50 WIDE TYNES
3	1	UB1004		U BOLT FOR 28 WIDE TYNES
2	1	TG1175		LUG - FOR 50 WIDE TYNES
2	1	TG1173		LUG - FOR 28 WIDE TYNES
1	1	TG1170		TRASHGUARD
REF	QTY	PART No	DRG SIZE	DESCRIPTION

ALL RIGHTS STRICTLY RESERVED
REPRODUCTION OR ISSUE TO THIRD
PARTIES IN ANY FORM WHATEVER
IS NOT PERMITTED WITHOUT WRITTEN
AUTHORITY FROM AGMASTER.

AGMASTER
2067 MARSHALL ST. COLLIE WA 6225

ASSY INSTRUCTIONS
TRASH GUARD

AI1025